



TWINSENSES

CDS | PROPERTY
COSTA DEL SOL





Twin Senses Villas Designed to inspire

Ideally located on the Cost del Sol's prestigious New Golden Mile, this attractive boutique collection of 15 four bedroom private villas promises a life of luxury and ease. Each home boasts a contemporary design accented with natural materials, conveniently located close to the chic yachting marina of Puerto Banús and the exclusive seaside resort of Marbella. Twin Senses Villas offer the perfect setting for modern, exclusive living.



Crafted for Luxurious Comfort

The project, created by the architects at Atelier Lopezneiraciaurri in collaboration with the team at Avantia Promociones y Servicios, underscores the exceptional quality and innovation of this superior collection of homes, creating a benchmark for the area in private luxury villas.

Spacious, airy and comfortable, the villas are conceived as two large volumes, placed one on top of the other, that ingeniously seem to slide and overlap, creating welcoming shady porches and terraces. Their design, anchored by wood-panelled sides, allows for extensive floor-to-ceiling windows that maximise natural light and views.

Infused with a contemporary aesthetic, the residences boast large wrap-around terraces, as well as natural wood finishes that seamlessly connect them to the surrounding landscape, capitalising on the indoor-outdoor style of living that is so representative of Southern Spain.

The open plan layout ensures effortless movement through the space, with the wide windows flooding living areas with natural light, each glance framing a unique view of the gardens.

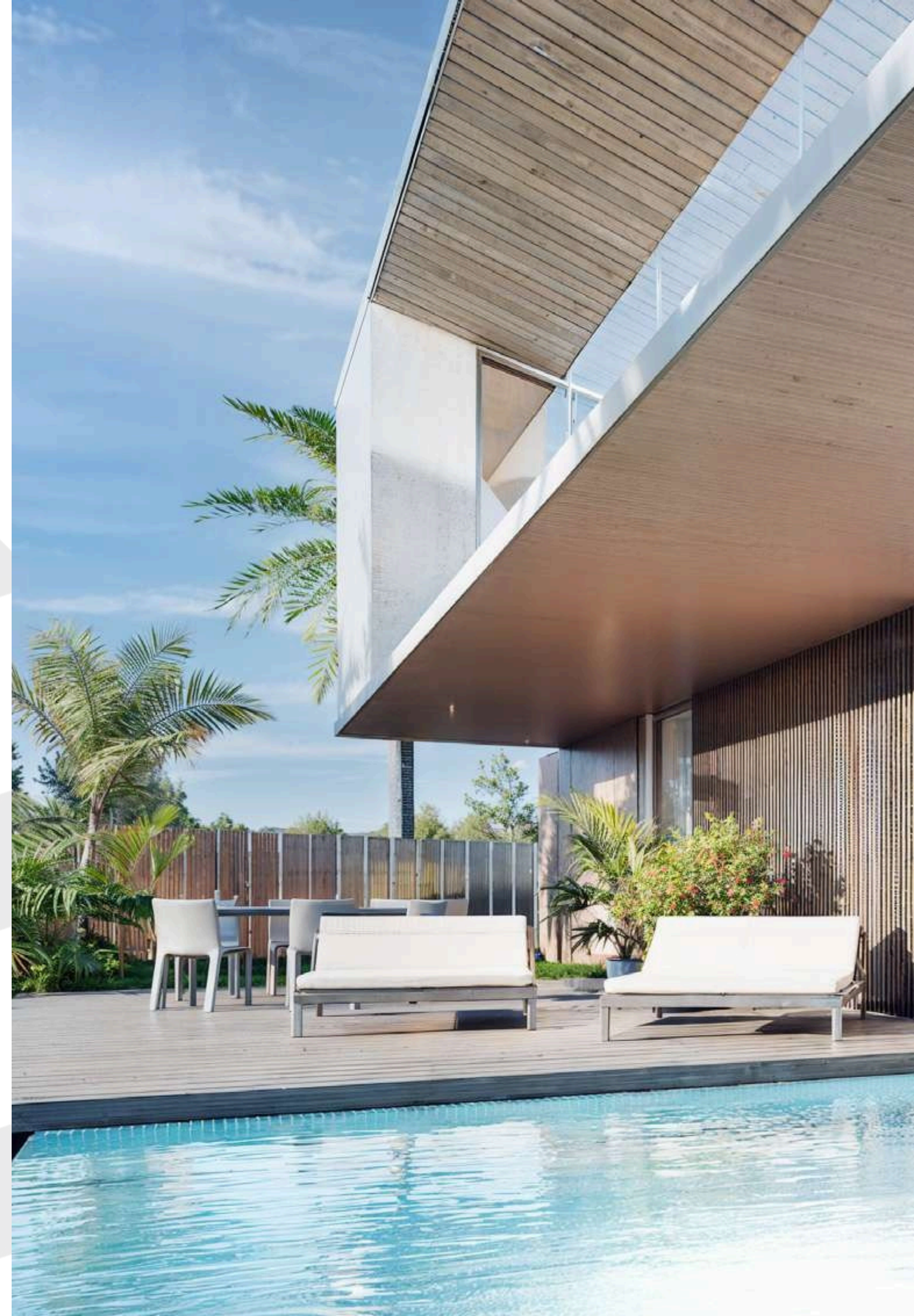



Welcome to Your Sanctuary

The villas are carefully curated to serve as tranquil sanctuaries, where residents can relax and rejuvenate amidst modern comforts. Upon entering the ground floor, it's clear the living space is thoughtfully designed for ease and comfort. The generously sized corner lounge area is surrounded by glass, with three expansive floor-to-ceiling windows framing picturesque garden views and enhancing the overall ambience viewed through tranquil, shaded terraces.

The adjacent dining room enjoys further views of the gardens, with a warm atmosphere inviting relaxed lunches and convivial dinners, while the kitchen is found in the far corner of the downstairs area. Fully fitted and furnished with high-quality SIEMANS appliances, the work surfaces are DEKTON throughout, including the island which is both attractive and functional. Yet another large window offers dedicated chefs the luxury of cooking with a view towards the garden.











Sweet Dreams at Twin Senses

A floating staircase leads you to the upper floor, where abundant sunshine pours through a grand skylight. Positioned strategically, a home office space offers views of the garden through a vertical window, tucked in a quiet nook. This floor primarily hosts the sleeping quarters, featuring three spacious bedrooms, each with its own en-suite bathroom equipped with a fabulous walk-in shower.

The impressive master suite occupies the southeast corner of the first floor, exuding luxury and tranquillity. Its extensive layout provides ample space for rest and relaxation. Furnished with exclusive ROCA fittings, the master bathroom boasts a double sink unit, a luxurious bath, and walk-in shower. Completing the suite is a lavish dressing room. The master bedroom's corner setting showcases floor-to-ceiling windows, granting access to a sprawling wrap-around terrace with panoramic garden views below.





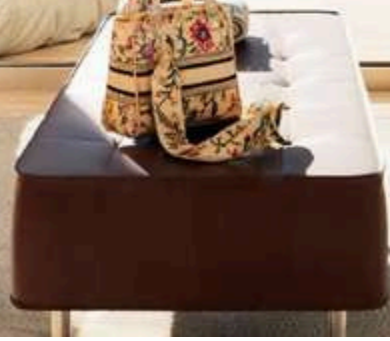

Seamlessly At One with Nature

Outside, the ambience is no less opulent. Generous-sized plots offer landscaped gardens featuring private infinity pools. They also boast that modern luxury essential, an outdoor gourmet kitchen, to take advantage of intimate evenings under the stars or entertaining friends and family in style.

High-quality finishes are seen throughout, with natural stone, wooden panelling, and stainless steel used to stunning effect. These elements not only enhance the contemporary aesthetic but also imbue the spaces with warmth and sophistication, enhancing every corner of the villa.







Your Unique Space, Your Style

The lower ground floor is yours to customise as you wish, with an endless possibility of combinations to choose from. As well as a laundry room, two expansive spaces enjoy natural light through large windows and a skylight with views of the lush garden and a water feature bringing the sensation of the outside in.



Whether it's the addition of a bedroom, private cinema, gym, playroom, bar or cellar, the potential is available in whichever configuration suits your family's lifestyle. A bathroom as well as Hammam completes this most versatile of spaces.

Twin Senses Villas presents a unique opportunity to own a luxury private residence in an enviable location near golf courses, beaches, and the premier destinations of the Costa del Sol. Crafted with an emphasis on beauty, comfort, and luxury, these villas are poised to set a new standard for upscale living in the region.

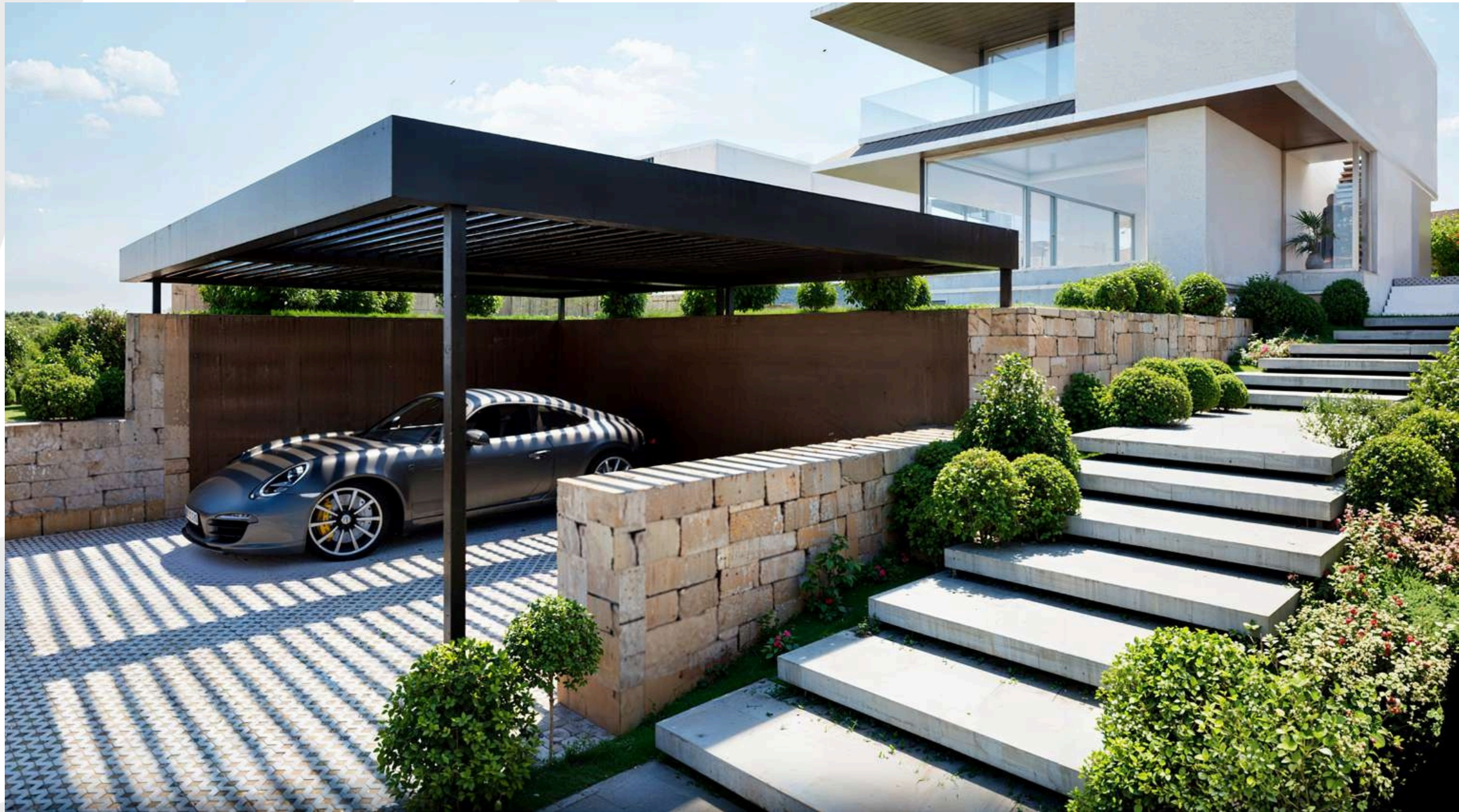

Serenity and Convenience An Enviably Location

The New Golden Mile's fashionable reputation has flourished thanks in part to its proximity to the stylish resorts of Marbella and Puerto Banús. It can also thank Estepona, the 'Garden of the Costa Del Sol', for its surge in popularity as a prestigious destination.

Twin Senses Villas is within easy reach of each of these thriving localities and yet is surrounded by nature promising a tranquil environment of peace and laid-back living. The enviable Costa del Sol climate that sees the sunshine for 320 days a year on average can be enjoyed whatever the season on the long, golden beaches that lay within walking distance.

Situated in the heart of the El Campanario residential urbanisation, Twin Senses Villas are in a privileged position steps from the golf course and superior amenities of the El Campanario Golf and Country House. Even more enticing for golf enthusiasts, there are several prestigious courses within a short radius, including Atalaya Golf and Country Club, Los Flamings Golf Club and the Real Club de Guadalmina.

Meanwhile, amenities such as supermarkets, schools, banks, and pharmacies are minutes away. Also nearby are bars and restaurants boasting a wealth of tantalising gourmet offerings, from the freshest of seafood to haute cuisine.



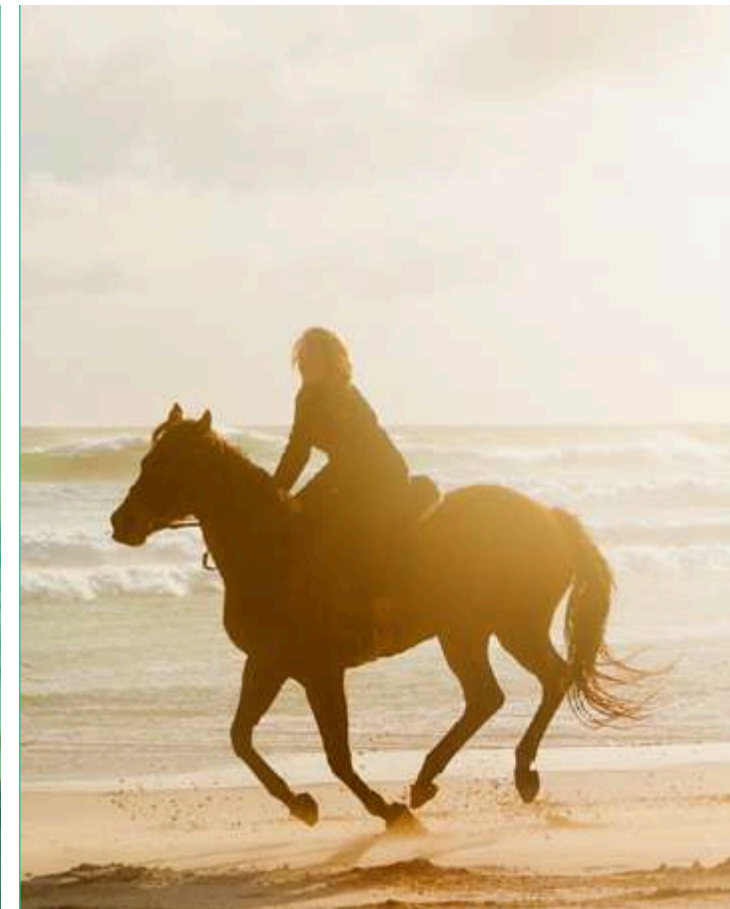
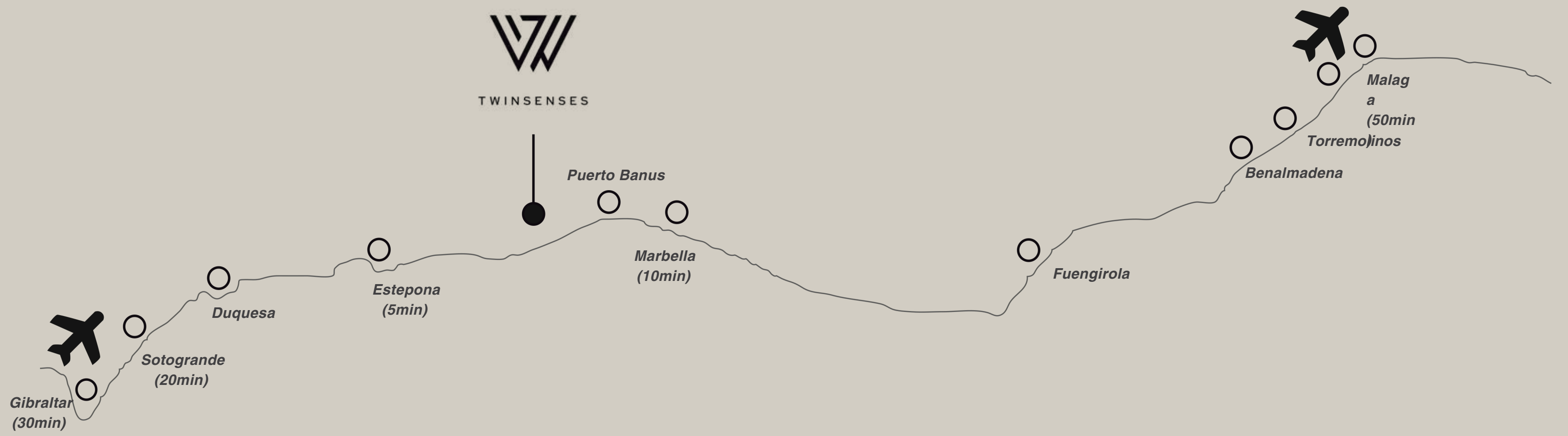



Designed on sustainability and energy efficiency .



Experience the difference of the modern build: it's not just construction, it's an artistry of Quality, Precision, Modernity, Comfort, and Luxury designed to delight your senses. With a heritage of respecting traditional methods, we blend history with innovation, rooted in the latest advancements in construction technology and industrial processes. A commitment to excellence means only the finest construction systems are utilized, ensuring your home is equipped with the ultimate comfort through cutting-edge solutions. From certified Passivhaus systems to those endorsed by the esteemed Institute of Construction Technology (ITeC), every detail is meticulously crafted to exceed your expectations.

At the core of these villas lies a rigorous quality control process, ensuring every aspect of your home meets the highest standards. From initial design to final construction, we integrate our innovative approaches seamlessly, delivering closed and tested units that undergo intensive quality assurance. While we cherish traditional materials such as concrete, stone, steel, wood, and glass, we reimagine their application with a sophisticated industrialized touch, avoiding the imperfections of common construction practices.

Discover the difference: superior finishes, expedited timelines, and most importantly, the satisfaction of our valued customers. Experience the epitome of luxury living at Twin Senses..



TWINSENSES

More informacion: +34 606 745 777 | thomas@cdsproperty.es
www.cdsproperty.es

CDS | PROPERTY
COSTA DEL SOL

All the information contained in this document has been prepared from the Preliminary Project of the property or, where applicable, from the Basic Project of the same, being therefore neither definitive nor contractual, and may undergo variations until the drafting of the Final Execution Project. Infographics are merely indicative images; decoration, landscaping and furniture are not found included in the goods being marketed.