



ALTOS
DE SAN PEDRO III

LOCATION



Calle Vélez Blanco, San Pedro del Pinatar, Murcia

LOCATION

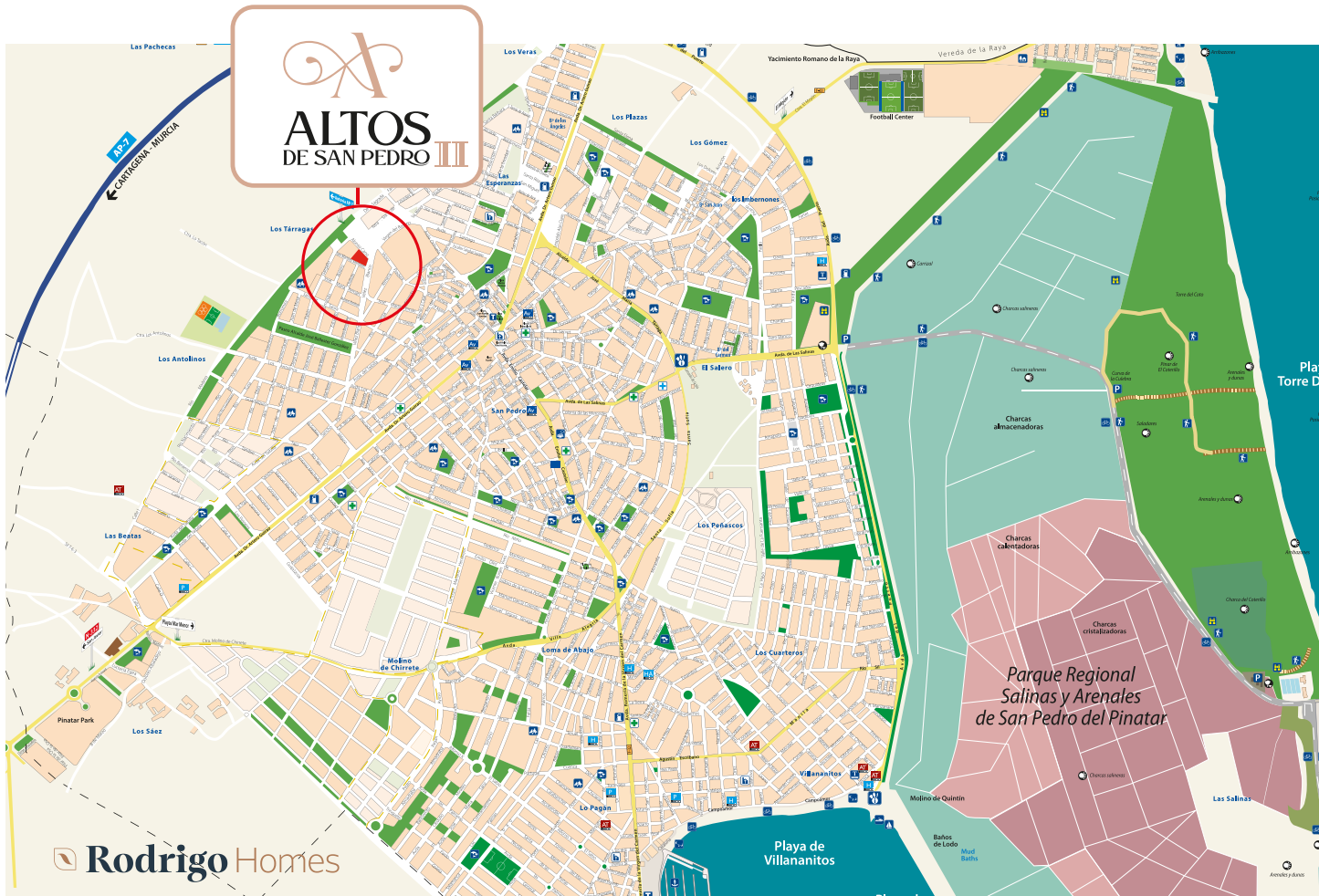

- | | | | | | |
|---|---|---------------|---|--|---------------|
|  | Aeropuerto de Murcia / Murcia Airport | 25 Km |  | Playas Mar Menor / Mar Menor beaches | 2,0 Km |
|  | Aeropuerto de Alicante / Alicante Airport | 50 Km |  | Centro / Center of the town | 400 m |
|  | Estación de tren / Train Station | 13 Km |  | C.C. La Zenia / La Zenia Shopping Center | 10 Km |
|  | Playas Mediterráneo / Mediterranean Sea | 3,0 Km |  | C.C. Dos Mares / Dos Mares Shopping Center | 2,0 Km |

 **Rodrigo Homes**

STANDARD PLAN

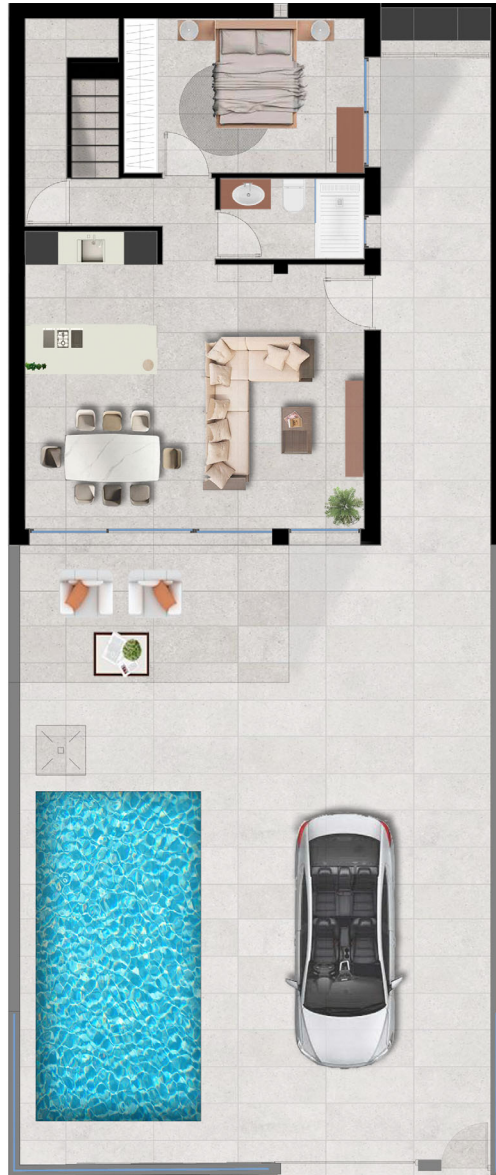

Ground floor



First floor

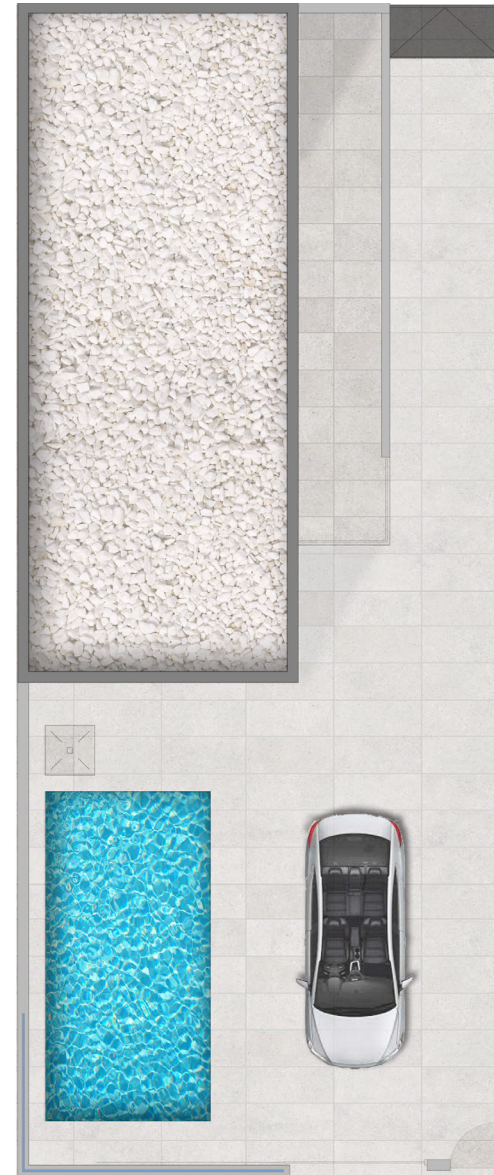

Ground floor

First floor

STANDARD PLAN - SOLARIUM OPTIONS

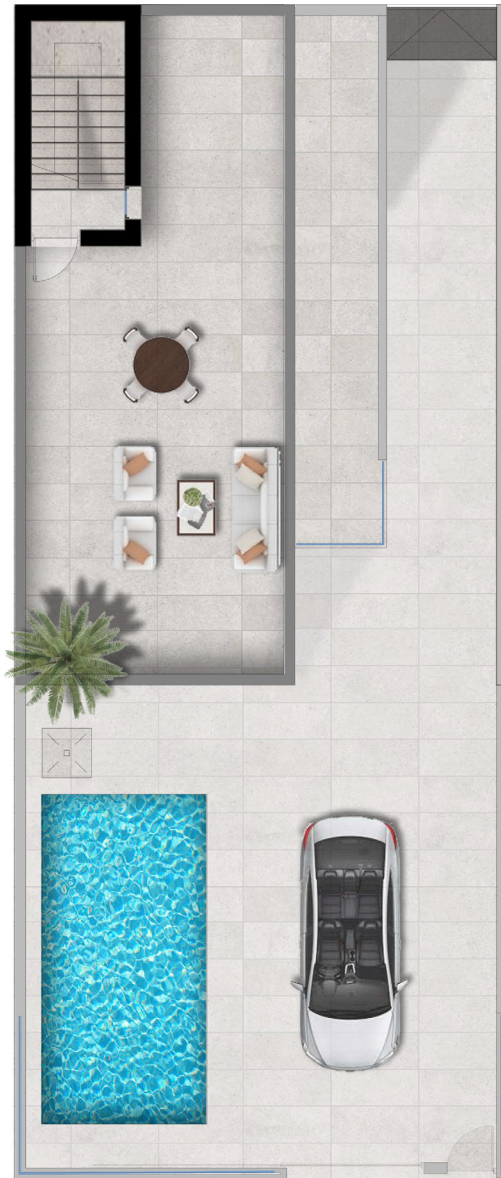

Solarium with tower



Solarium with bedroom
and bathroom



GENERAL PLAN

PARCELA	SUP. PARCELA	M2 CONST.
1	203,41 m ²	112,50 m ²
2	187,22 m ²	112,50 m ²
3	172,41 m ²	112,50 m ²
4	161,83 m ²	112,50 m ²
5	162,86 m ²	112,50 m ²
6	186,47 m ²	112,50 m ²
7	178,98 m ²	112,50 m ²
8	160,30 m ²	112,50 m ²
9	161,45 m ²	112,50 m ²
10	172,08 m ²	112,50 m ²
11	202,43 m ²	112,50 m ²
12	203,41 m ²	112,50 m ²









QUALITY LIST

FOUNDATIONS AND STRUCTURE

- Reinforced concrete foundation and structure, according to CTE (Spanish Technical Building Code).

FAÇADE AND PARTITIONS

- Façade enclosure with external wall in honeycomb bricks of 11 cm and interior plaster board, with thermal and acoustic insulation, according to CTE.
- Plaster board internal partitions, finished with a spray-applied plaster surface on both sides.
- Facade made combining a monolayer mortar and thin plaster, painted with plastic paint and ceramic stoneware.

SOLARIUM

- Optional

FLOORING AND TILING

- Porcelain flooring inside the house, garden and terrace.
- Bathrooms and kitchen tiled with porcelain stoneware.

OUTDOOR CARPENTRY AND LOCKS

- PVC outdoor carpentry, with hermetic sliding doors, motorized blinds in large windows, thermal aluminium blinds in the rest of windows. **Laminated double glazing in balcony windows.**
- Tilt windows in bathrooms. Garden gate doors with thermocoated metal profiles, design according to management.

INDOOR CARPENTRY

- Interior wooden doors, lacquered in white. Design according to management.
- Built-in wardrobes in all bedrooms. **Interior lining of wardrobes, with drawers, shelves and coat rack.**

HEATING AND AIR CONDITIONING

- Conducts pre-installation of air conditioning per floor.

PLUMBING, SANITARY WARE AND SHW

- Hot and cold water plumbing installation with PPR piping system. In compliance with CTE. Stopcocks in each wet room.
- Top-quality porcelain sanitary ware. Suspended WC with built-in cistern in both bathrooms. **Modern design furniture** with porcelain sinks and mirrors. **Rainfall shower column.**
- Anti-slip shower tray in both bathrooms.
- Aerothermal domestic hot water system, according to CTE.
- **Shower screen** with transparent safety glass in both bathrooms.
- Outdoor tap in the garden.

ELECTRICITY AND TELECOMMUNICATIONS

- Electrical panel. 9 distribution circuits. 4 TV points. DTT aerial according to project. Pre-installation for optical fibre connection. White Simon 82 mechanisms or similar ones.
- TV points in all bedrooms and garden.
- Video intercom with interior monitor with a 7" colour screen, for pedestrian garden gate control.
- Interior led lighting in the whole house (except for lamps in bedrooms). Facade wall lights integrated in the garden wall.
- Installation of photovoltaic solar panels
- Preinstallation for awnings in façade

POOL AND GARDEN

- Reinforced concrete pool. Stainless steel shower included, sprayed concrete vessel and reinforcement and walls and floor cladding with tiles. Complete water treatment equipment. Led lights.
- Parking area per property.

DECORATION AND PAINTING

- Walls and ceilings 'smooth finish with white plastic paint. Smooth plaster ceilings in corridors. Bathroom ceilings with laminated gypsum boards and decorative vinyl..

KITCHEN

- Design kitchen units with fridge and dishwasher embedded. Shock absorber hinges with Blum Motion system and metal handles. **Synthetic marble worktop or similar.**
- **Balay electrical appliances** are included (induction cooker, oven and microwave on top, extractor fan, built-in fridge and dishwasher, and washing-machine).



ALTOS
DE SAN PEDRO III