

- BRA 212.5 m<sup>2</sup>
- BRA 1 floor 112.9 m<sup>2</sup>
- BRA 0 floor 102.9 m<sup>2</sup>
- BYA 135.3 m<sup>2</sup>

Project: Fjellesola VI  
 Drawing: 1 Floor

Date: 26.06.2019  
 Scale: 1:100

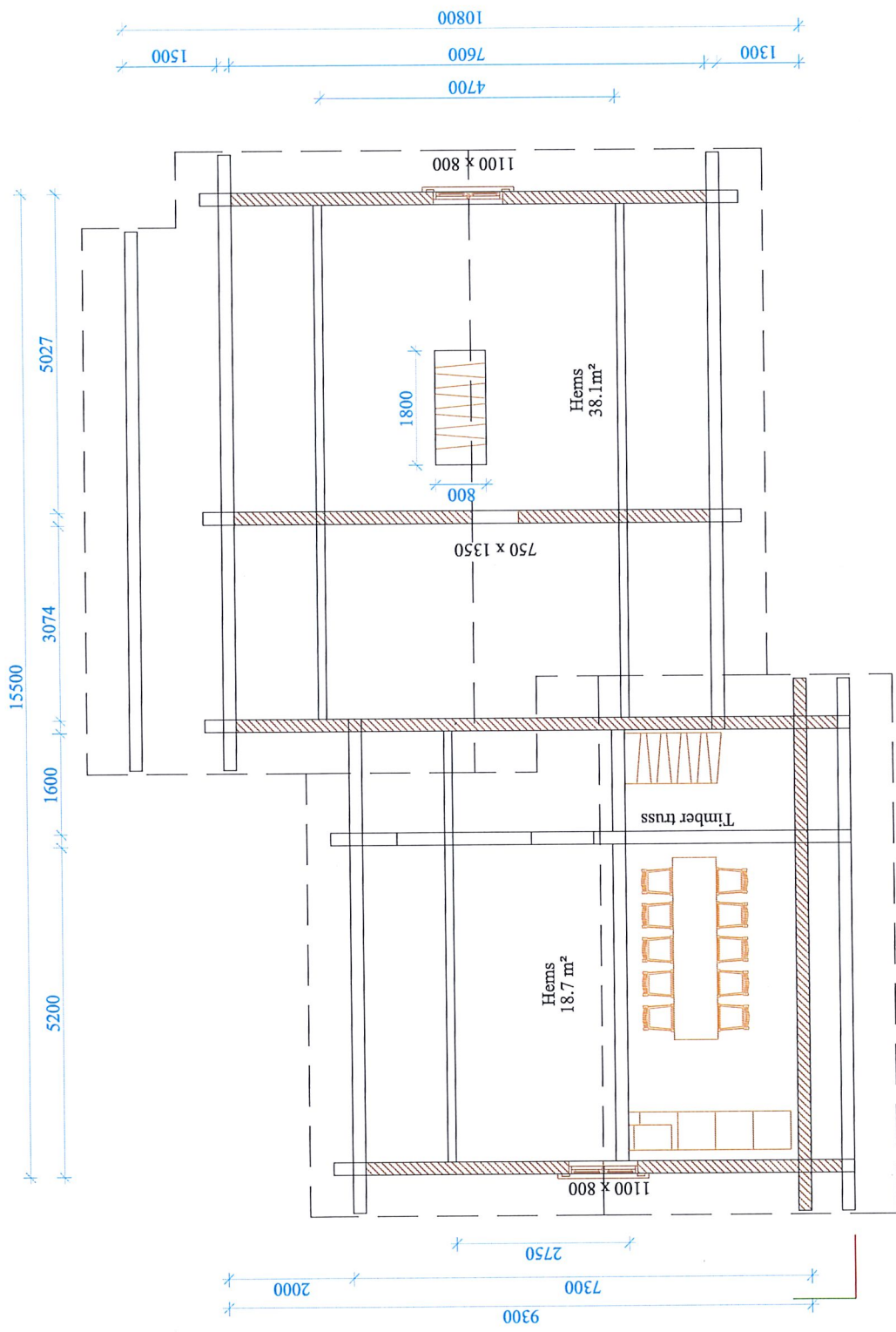

Project: Fjellesola VI

Date: 26.06.2019

Drawing: 2 Floor

Scale: 1:100