

## BUILDING SPECIFICATIONS







## KITCHENS

The kitchen, integrated into the living room, is equipped with large capacity upper and lower cupboard units, self-closing doors, brake, and hidden handles. The units are lacquered in a colour of your choice from the personalisation options given, with a compact quartz worktop and oven front panel by **Silestone** or similar.

The kitchen also includes a vitro-ceramic hob, electric oven, and extractor system. There is a single stainless-steel sink with a mixer tap.

\*As part of our personalisation programme, you can choose from various colour options for the kitchen cupboards.





## **BATHROOMS**

The bathrooms have a unit with two drawers, and an integrated washbasin with a mixer tap. The mirror above the unit is also included. The WC in both bathrooms is in white vitrified porcelain. The showers have a fixed shower screen and a white acrylic shower tray. The floors and walls have ceramic tiling.

In the townhouses, basements will have a pre-installation for an extra bathroom.

\*As part of our personalisation programme, you can choose from various colour options for the bathroom floors and walls.





## *Easy Living Costa Blanca*



### **CARPENTRY**

The armoured main entrance door to the home has a spyhole, anti-leverage hinges, and a security lock. The interior doors are plain and finished in white.

The fitted wardrobes, floor to ceiling, also have plain doors in white. The interiors are lined with melamine and have a luggage shelf and a hanging rail.

Exterior carpentry is PVC or aluminium, with double-glazed windows and patio doors with thermal break and an air chamber.

The living room and bedrooms have motorised shutters with switches.

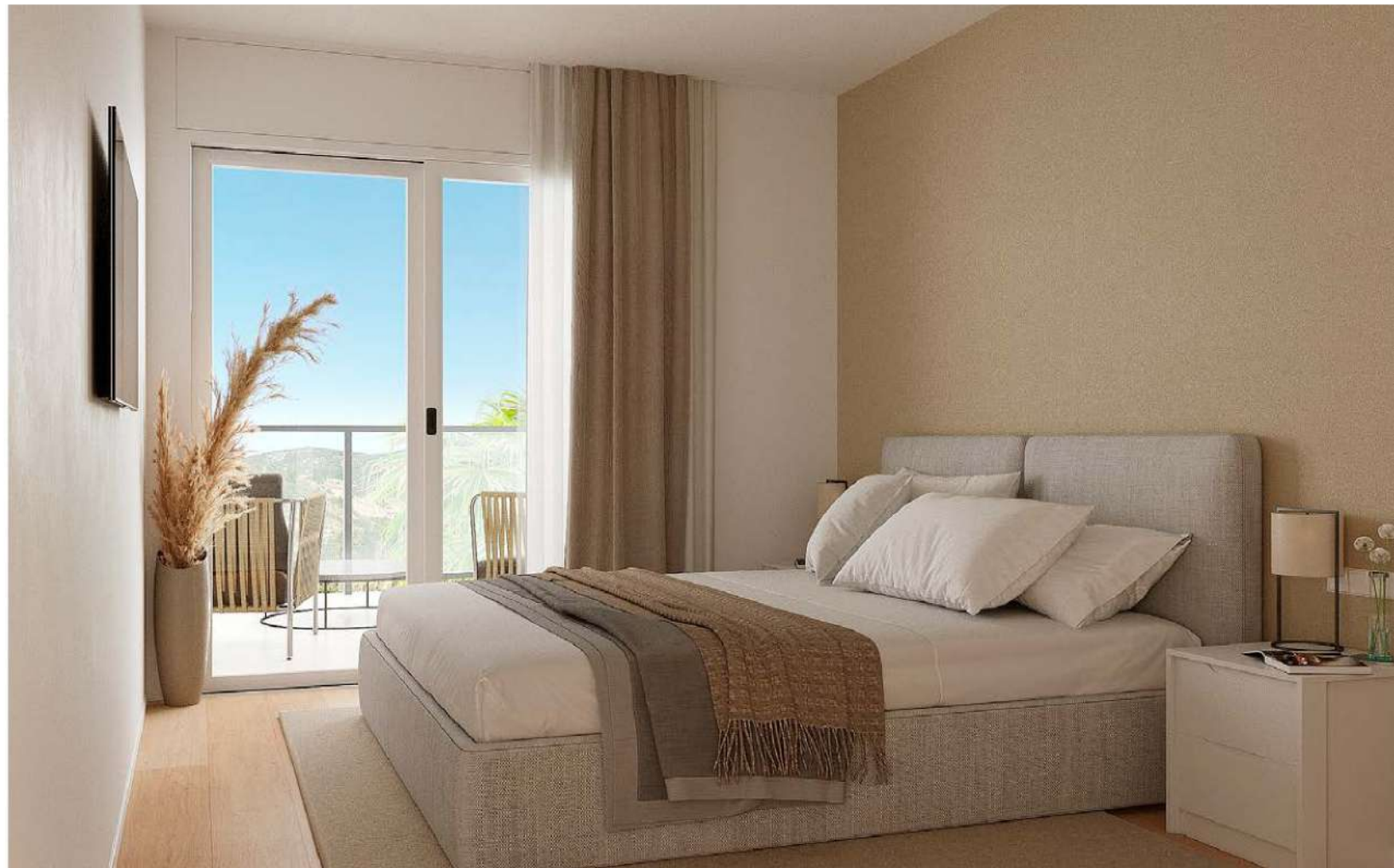



*Easy Living Costa Blanca*



## FLOORING

Inside the home, we have chosen laminate/parquet flooring with white skirting and the colour is to be decided.

Wet zones and terraces have ceramic tiling and artificial grass, according to the project plans.

\*As part of our personalisation programme, you can choose from various colour options for the flooring.

## FACILITIES

Each home has its own independent hot and cold air conditioning system via ducts with machinery included and centralised control. The townhouses will also have pre-installation for split-level air conditioning in the basement.

**Individual aerothermal system** for domestic hot water production. **Solar panels** provide extra electrical power to the townhouses, connected to the general fuse board. Telephone and TV-TDT-SAT sockets in living room and bedrooms. Terrestrial TV antenna and satellite dish.

The building also has the required insulation to walls, roofs and windows in order to obtain a high **energy efficiency rating “A”**.





*Easy Living Costa Blanca*



## EXTERIORS

Exterior communal areas have a pool for adults and children, as well as a children's play area with safety flooring.

The communal areas are landscaped and have completely accessible pathways. There is a parking zone for bicycles.

Every home has a private parking space with pre-installation for an electric vehicle charging point.

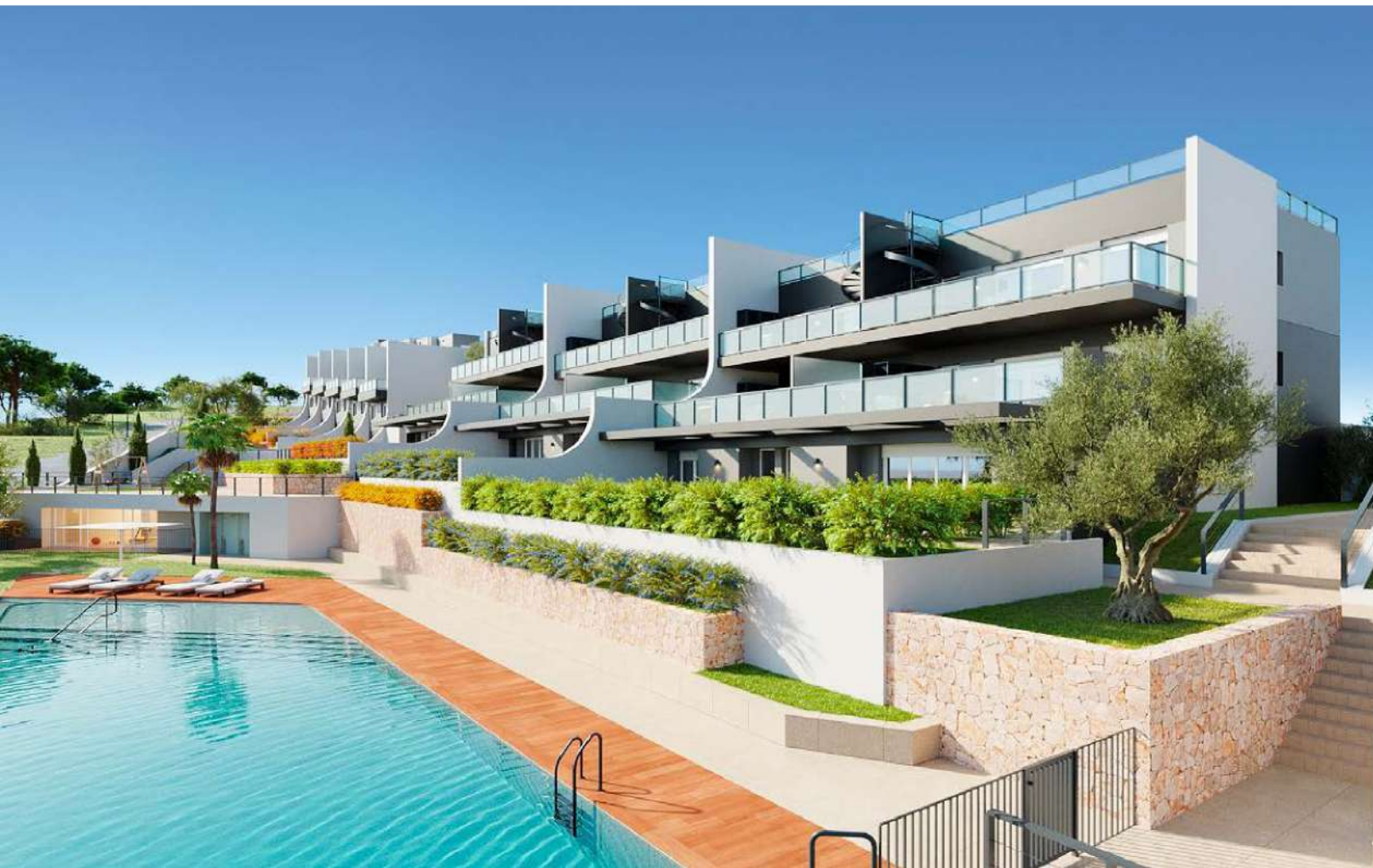



*Easy Living Costa Blanca*

## BALCÓN DE FINESTRAT

TAYLOR WIMPEY DE ESPAÑA, S.AU. reserves the right to modify or change the materials and distribution of the abovementioned specifications and plans to improve the project in accordance with the criteria of the project architects.

\*The images and project plans are purely for illustrative purposes. Its content does not constitute a contract, part of a contract or guarantee.

\*\*The personalisation options for the homes are those offered by the developer and choices must be made within the timeframe established to allow for the selection of materials and to avoid any delay in the progress of the construction work.

